

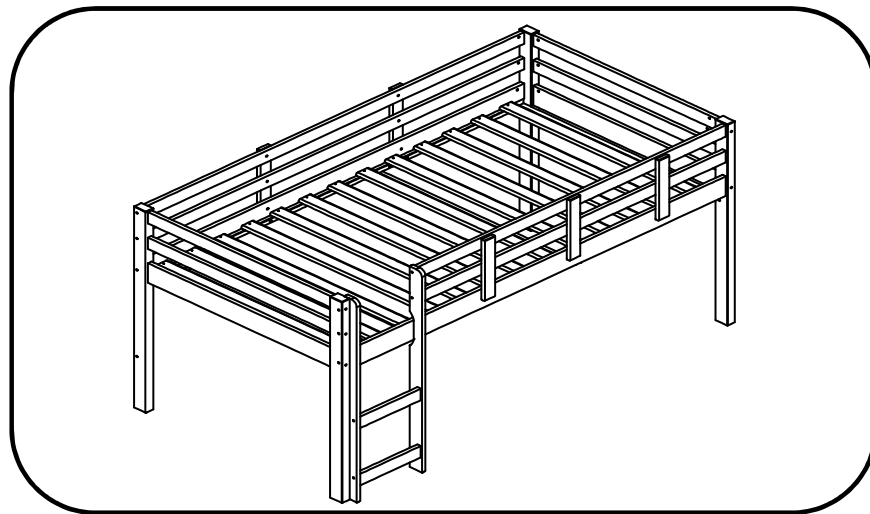

Low Loft Bed with Ladder



Assembly Instructions

Product Dimensions:
78" L x 42.5" D x 43.25" H

Please take a moment to read through the entire instruction booklet before assembly to familiarize yourself with this product. Once you feel ready to start, follow the instructions step by step and this should make this process as easy as we could make it for you.

If you need help or have damaged or missing parts, contact customer service at www.NaomiHome.com.

© 2018 Naomi Home Inc. - All Rights Reserved.

WARNING CAUTION

ADULT ASSEMBLY REQUIRED

CHOKING HAZARD

- This product includes small parts, sharp points and sharp edges in its unassembled state. Keep unassembled parts away from children under 3 years of age, and animals.

STRANGULATION HAZARD

- Never attach or hang items to any part of the loft bed that are not designed for use with the bed; for example, but not limited to hooks, belts, and jump ropes.

SIZE OF MATTRESS

- A twin size mattress of 75" Length x 39" Width x 6 Inch Thickness (190.5 x 96.5 x 15.24 cm) is recommended. Surface of mattress must be at least 5 inches (12.7 cm) below upper edge of guardrails. Maximum mattress and foundation combined thickness of 8 inches (20.3 cm).

SAFETY WARNINGS

- Follow the information on the warnings appearing on the loft bed end structure and on the carton. Do not remove warning label from bed.
- Always use the recommended size mattresses or mattress supports, or both, to help prevent the likelihood of entrapment or falls.
- Surface of mattress must be at least 5 inches (127 mm) below upper edge of guardrails.
- Do not allow children under 3 years of age to use the loft bed.
- Do not use substitute parts. Contact the manufacturer or dealer for replacement parts.
- Use of a night light may provide added safety precaution for a child using the loft bed.
- Always use guardrails on both long sides of the loft bed. If the loft bed will be placed next to the wall, the guardrail that runs the full length of the bed should be placed against the wall to prevent entrapment between the bed and wall.
- The use of water or sleep flotation mattresses is prohibited.

PARENTAL SUPERVISION IS REQUIRED

- This Naomi Home Kids product is intended for child use age 3+.
- Parents or Guardians should supervise use under the intended age specifically regarding children that may have access to it and climb on the unit.
- Do not allow horseplay on or under the bed and prohibit jumping on the bed.
- If used improperly, your low loft bed may be pulled over or fall, creating risk of injury or damage. Children should not be permitted to climb or pull on the low loft bed.
- Always use the ladder for entering or exiting the loft bed.

USE, MAINTENANCE & ASSEMBLY

- Periodically check and ensure that the guardrail, ladder, and other components are in their proper position, free from damage, and that all connectors are tight.
- Use on level surfaces only. Assemble on a soft level surface to avoid damage to unit or floor.
- Do not use this item if any components are missing or damaged.
- Do not use substitute parts. Contact the manufacturer or dealer for replacement parts.
- Only clean using damp cloth and mild detergent, do not use bleach or abrasive cleaners.
- Check you have all components and tools listed on page 4
- Do not stand or put weight on this product during assembly, this could cause damage.
- Remove all hardware from the plastic bags and separate them into groups.
- Assemble the item as close to its final position (in the same room) as possible.
- Certain assembly steps may be easier with 2 people.
- Dispose of all packaging carefully and responsibly.
- We do not recommend power screwdrivers. Only use hand screwdrivers to prevent damage to unit.

ASSEMBLY AT A GLANCE

Please take a moment to read through the whole instruction booklet before assembly to familiarize yourself with this product. Once you feel ready to start, follow the instructions step by step and this should make this process as easy as we could make it for you.

Due to the number of parts involved assembly can take a few hours so set aside between 2 and 3 hours to assemble this without rushing.

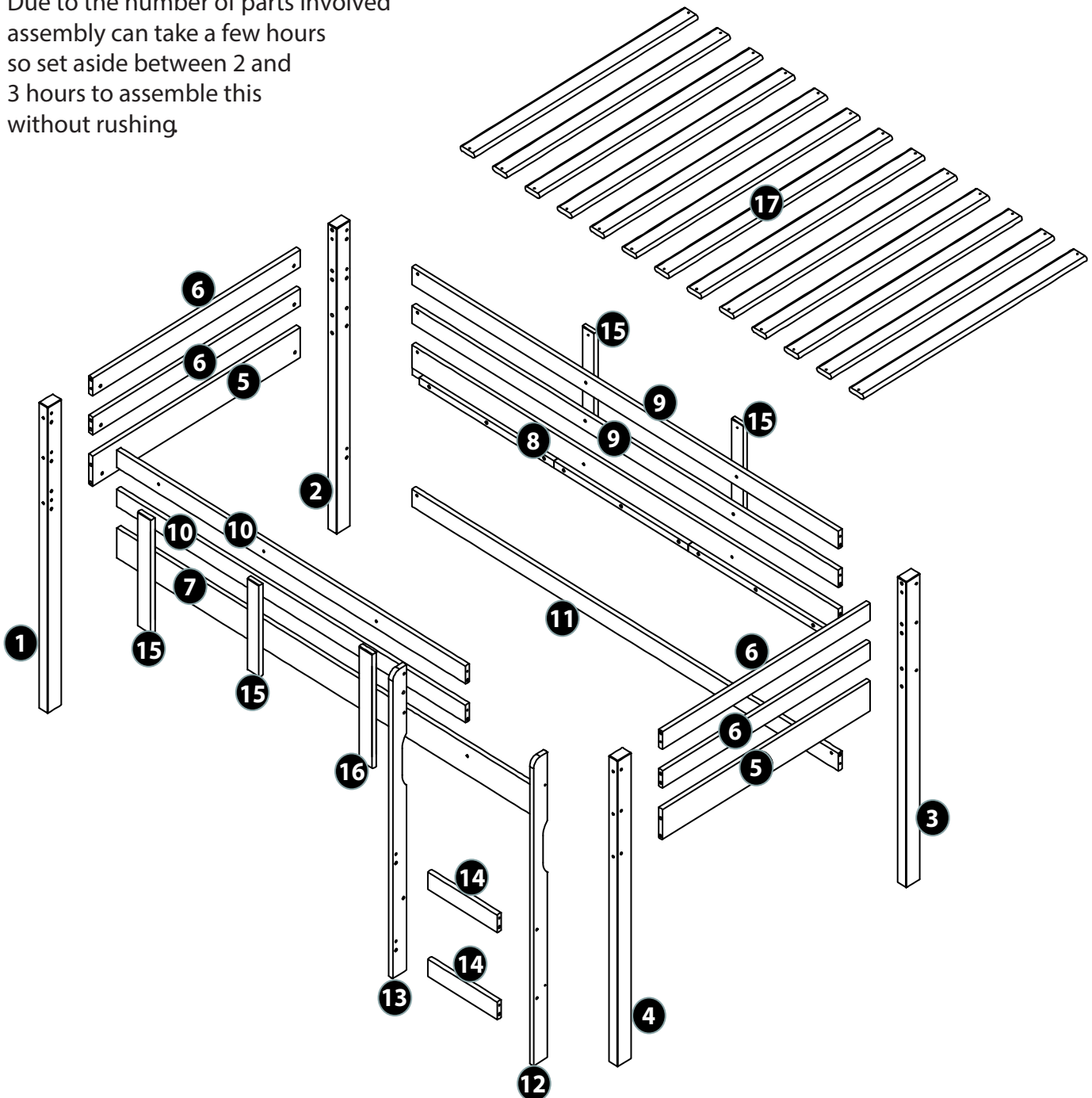

This drawing is to give you an overall idea only of how this assembly will go together and does not replace the assembly instructions.

COMPONENT PARTS

Please check that you have all the parts listed below

*Note: follow the setup of
of Option 1 for ladder right
configuration or Option 2
for ladder left configuration.

Each leg is unique.

1. Leg x1
2. Leg x1
3. Leg x1
4. Leg x1
5. Head/Footboard x2
6. End Rails x4
7. Ladder side board x1
8. No ladder side board x1
9. No ladder side rails x2
10. ladder side rails x2
11. Rear Leg Support x1
12. Right ladder rail x1
13. Left ladder rail x1
14. ladder rung x2
15. rail support x3
16. rail support by ladder x1
17. bed slats x13

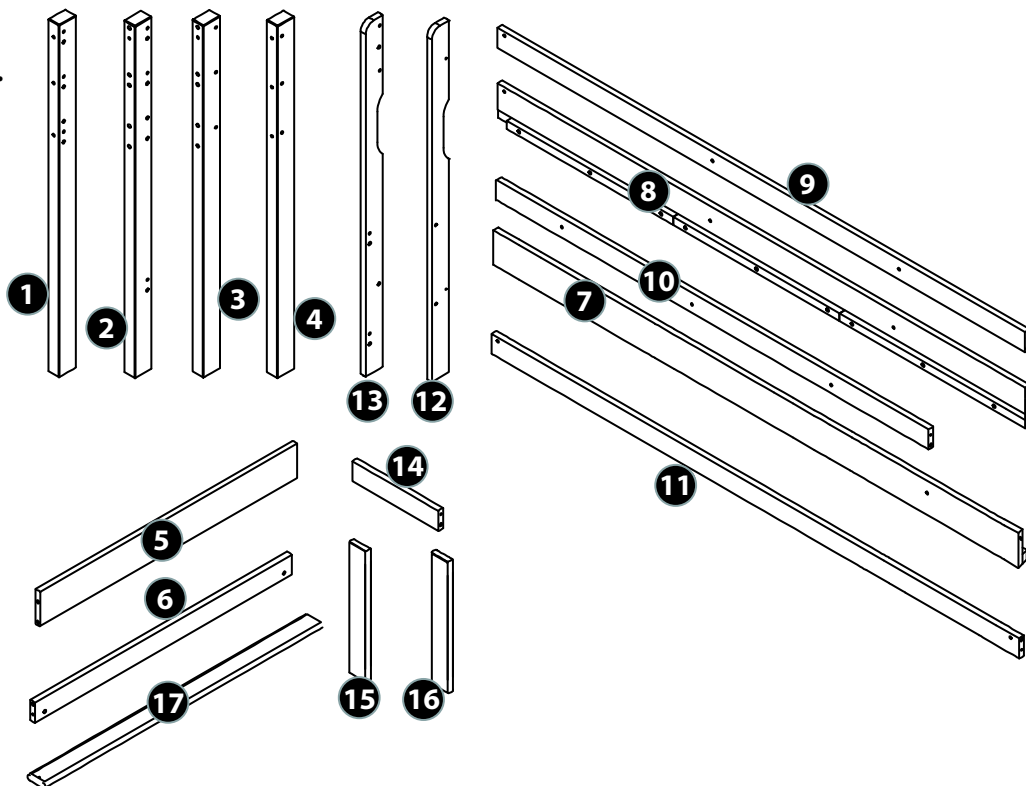

ASSEMBLY HARDWARE

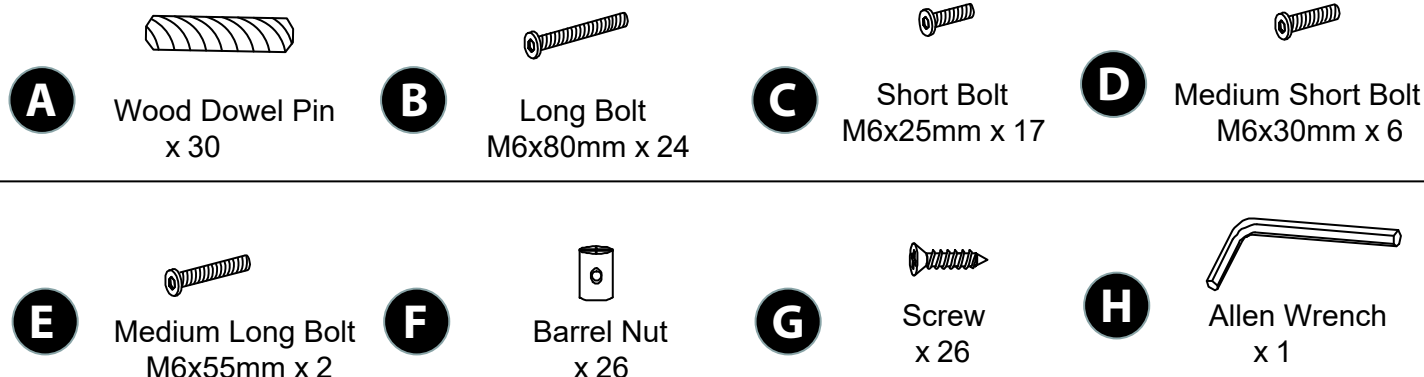

TOOLS REQUIRED



Phillips Screwdriver
(Medium)



Allen Wrench
(included)

ASSEMBLY INSTRUCTIONS

1

Select 1, 2, 5, 6 x2, A x6, B x6, F x6. On flat surface position 6 x2, and part 5 below 6. See large view - Insert F Barrel Nut into 6 while facing the threaded opening toward the end. Repeat F x5 in 6 and 5. Insert A x6 in top holes at ends of 6, and 5. Insert top 6 A dowel into top hole of 1. Insert B Bolt through 1 into hole of 6 and tighten with H allen wrench into barrel nut F. Repeat for other 6 and 5. Repeat A x3 and B x3 for leg 2.

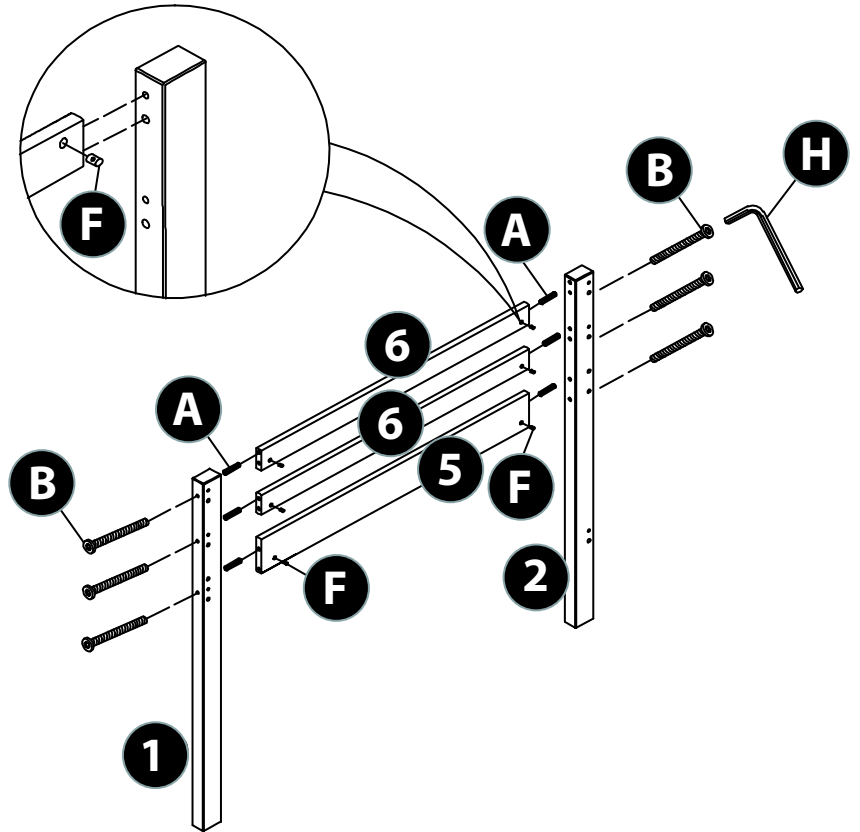

2

Select 3, 4, 5, 6 x2, A x6, B x6, F x6. On flat surface position 6 x2, and part 5 below 6. Insert F Barrel Nut into 6 while facing the threaded opening toward the end. Repeat F x5 in 6 and 5. Insert A x6 in top holes at ends of 6, and 5. Insert top 6 A dowel into top hole of 3. Insert B Bolt through 3 into hole of 6 and tighten with H allen wrench into barrel nut F. Repeat for other 6 and 5. Repeat A x3 and B x3 for leg 4.

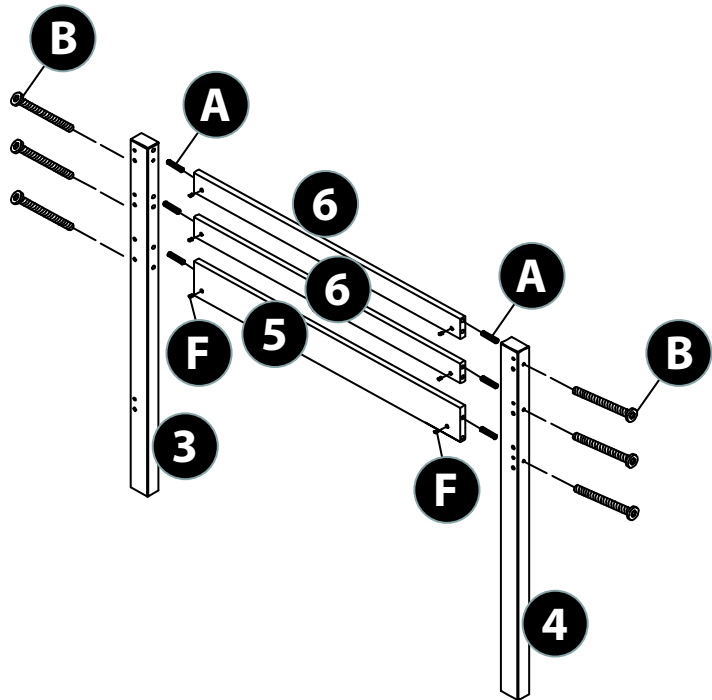

ASSEMBLY INSTRUCTIONS

3

Select 9 x2, 8, 11, 7, A x10, B x10, F x10. Insert A x2 into bottom holes in ends of 9. Insert F x2 into inside holes in 9. With F towards center, insert B through top hole of 3 and into 9 and secure to F. Finger tighten. Support 9 and 3 and repeat hardware steps at other end of 9 securing to leg 2. Repeat hardware steps for part 11 at bottom of 2 and 3. Select 7 and with bottom of "L" shape facing down and to center, attach 7 to 1 and 4 with A, B & F. Attach 2nd 9 board same as previous 9 just lower. Repeat steps for 7 for board 8 to leg 2 and 3. Use H allen wrench and tighten all B on all 4 legs.

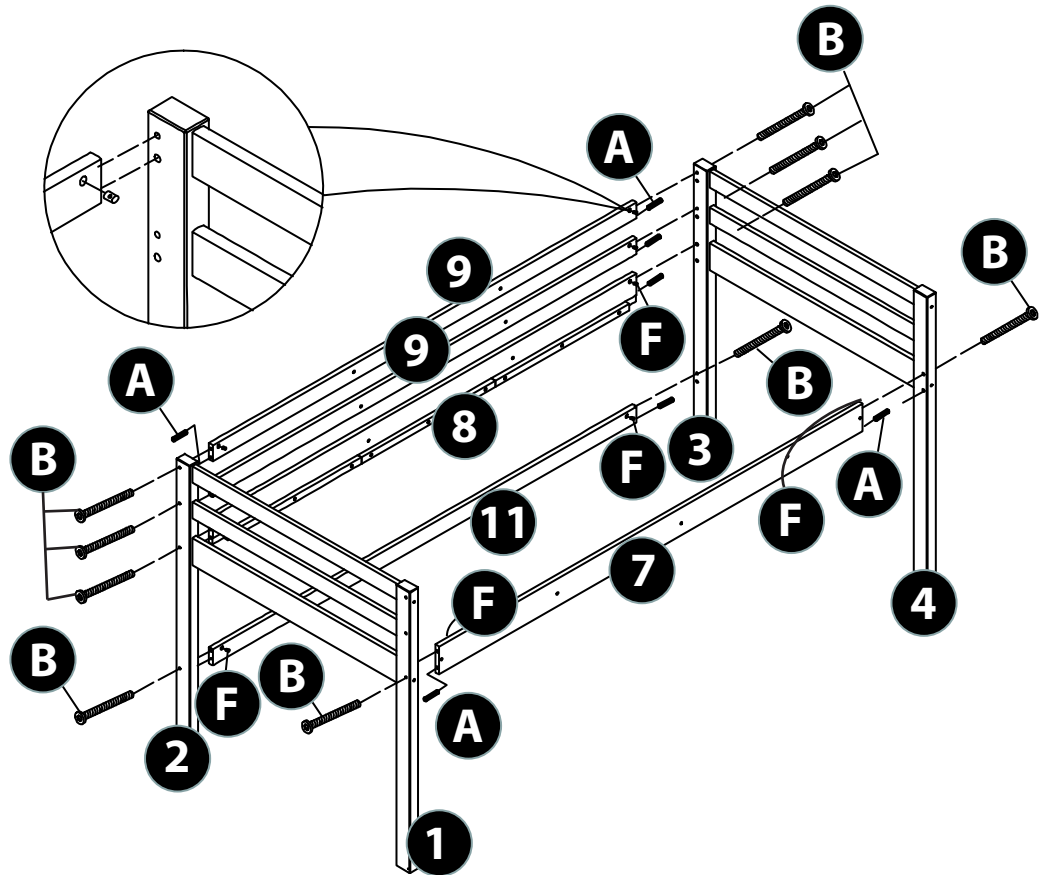

4

Select ladder parts 13 (left), 12 (right) and 14 x2, A x4, D x4. Insert A into bottom holes of 14. Repeat for other 14. Insert D through top hole in 12 and into end of 14 and finger tighten. Repeat for other end to 13. Attach other 14 using same hardware steps to bottom of 12 and 13. Use H allen wrench to tighten all D bolts.

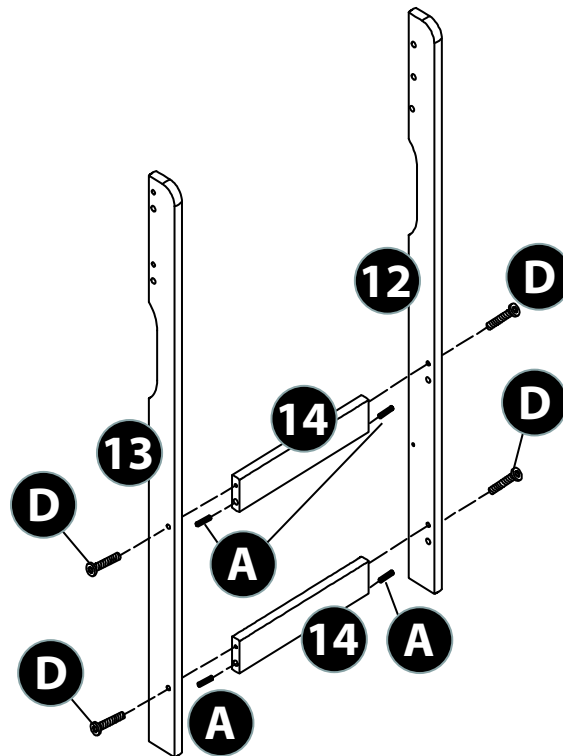

ASSEMBLY INSTRUCTIONS

5

Option 1 - Ladder Right Side. Select 10 x2, F x4, Bx2, A x2. Insert A into bottom holes of 10.

With F holes inside, support other end of 10 and attach 10 to leg 1 with B bolt and finger tighten. Continue support top board 10 other end, repeat and attach other board 10.

Do not stop support of either board. **Option 2 - Left Ladder - affix 10s to leg 4 instead of 1.**

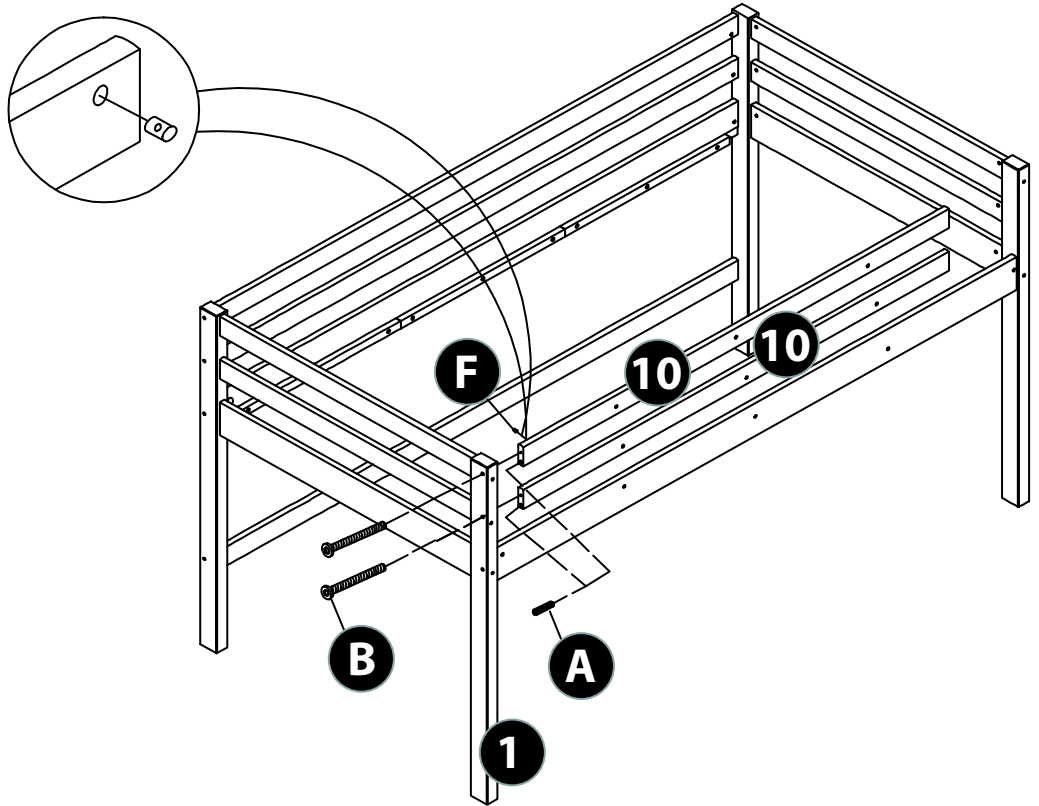

6

Option 2 Left Ladder- Skip to Step 8.

Option 1 - Bring in the ladder assembly and with 13 (facing ladder - left). Still supporting 10s, use C x2, and insert C through last hole of 7 by leg 4 and into 12 and finger tighten. Repeat C through 7 into 13. Select A x2, D x2 and insert A into ends of 10 x2. Insert D through top hole of 13 and into 10 and finger tighten. Repeat D for bottom hole on 13. Insert D through top hole of 12, and finger tighten. Insert D at bottom hole of 12 (between 14s). Use H and tighten 2 Cs in 7, 2 Ds in 12, 2 Ds in 13.

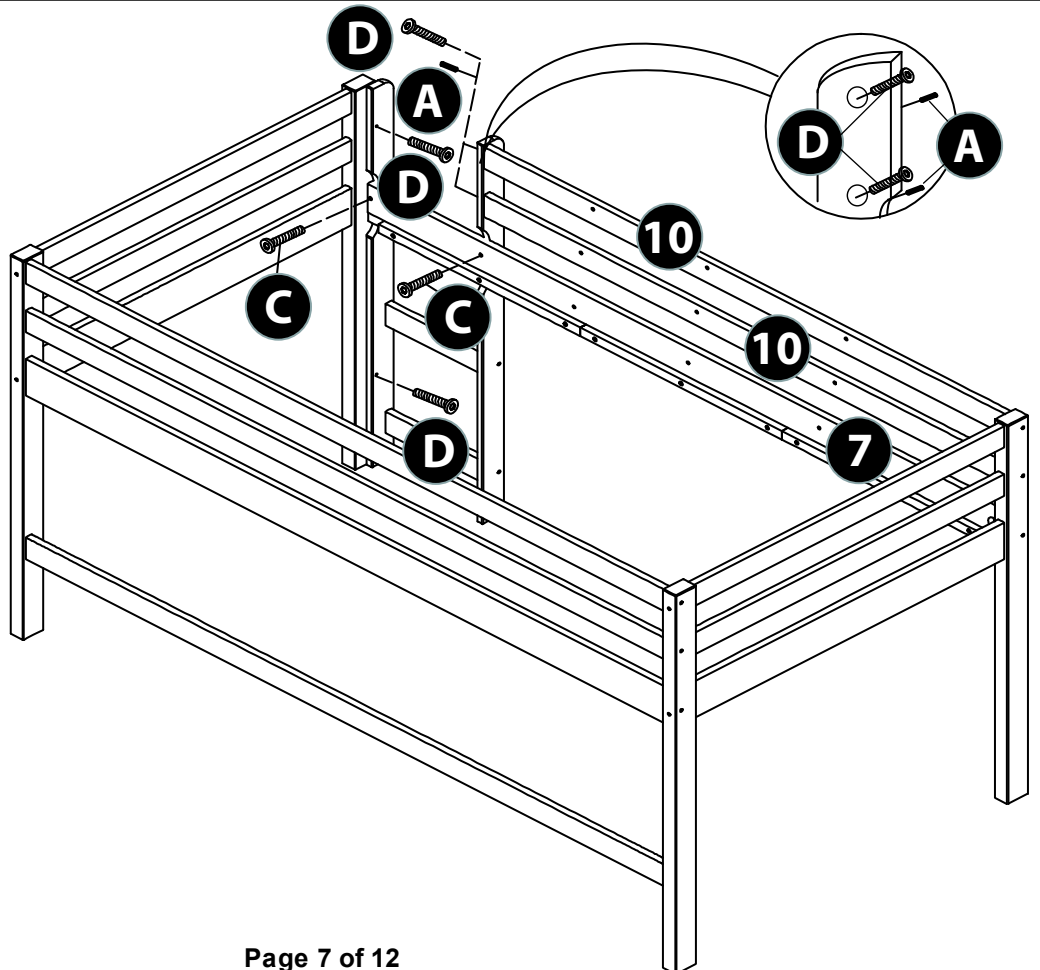

ASSEMBLY INSTRUCTIONS

7

Select 15 x4, 16, Cx15.
Attach 16 with C to 10s and 7 near ladder. Use C and attach 15s in other holes of 10 and 7. Use Cs and repeat for 15s x2 into back side 9s and 8. Use H to tighten all C bolts.

Option 1 - Ladder Right
Skip to step 10.

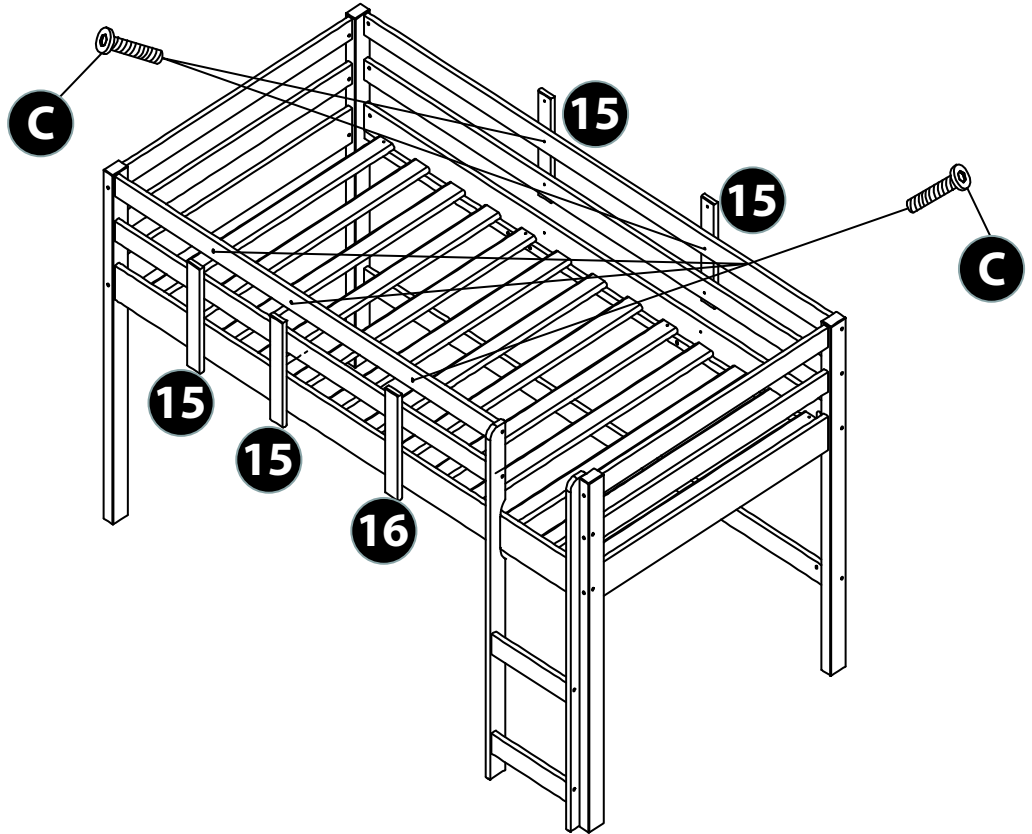

8

Option 2 - Ladder Left.
Bring in the ladder assembly and with 13 (facing ladder - left). Still supporting 10s, use C x2, and insert C through first hole of 7 by leg 1 and into 13 and finger tighten. Repeat C through 7 into 12. Select A x2, D x2 and insert A into ends of 10 x2. Insert D through top hole of 12 and into 10 and finger tighten. Repeat D for bottom hole on 12. Insert D through top hole of 13, and finger tighten. Insert D at bottom hole of 13 (between 14s). Use H and tighten 2 Cs in 7, 2 Ds in 12, 2 Ds in 13.

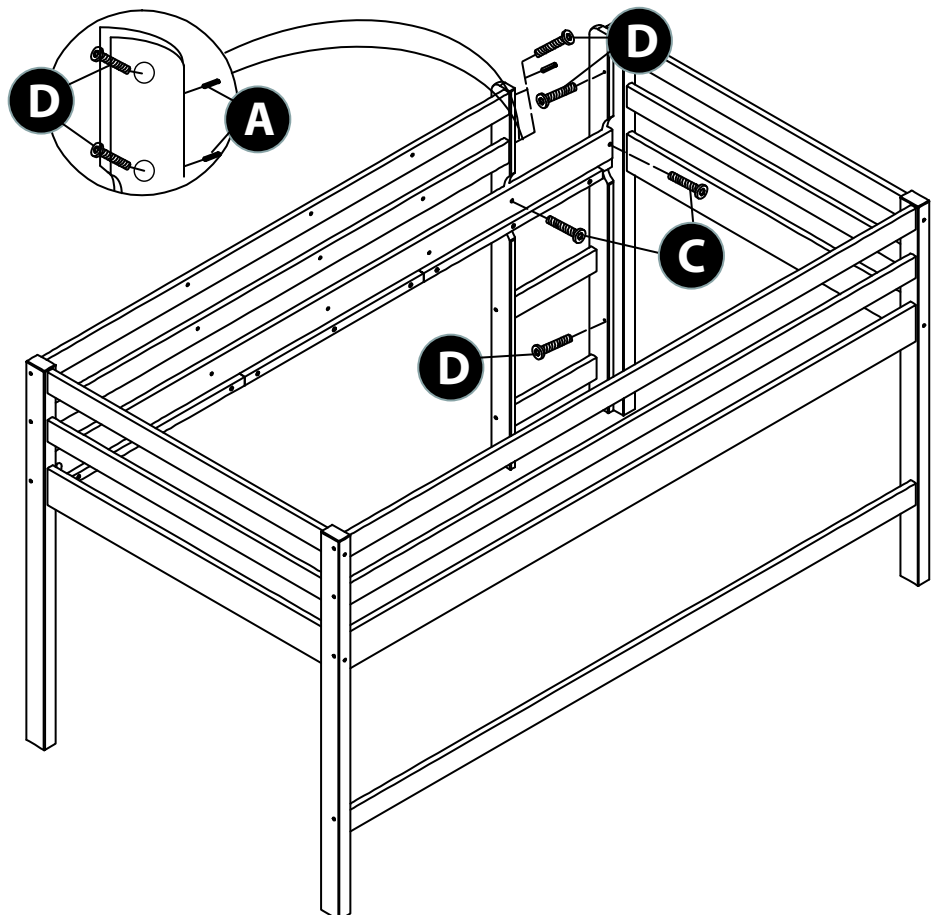

ASSEMBLY INSTRUCTIONS

9

Option 2 - Ladder Left.

Select 15 x4, 16, Cx15.
Attach 16 with C to 10s and 7 near ladder. Use C and attach 15s in other holes of 10 and 7. Use Cs and repeat for 15s x2 into back side 9s and 8. Use H to tighten all C bolts.

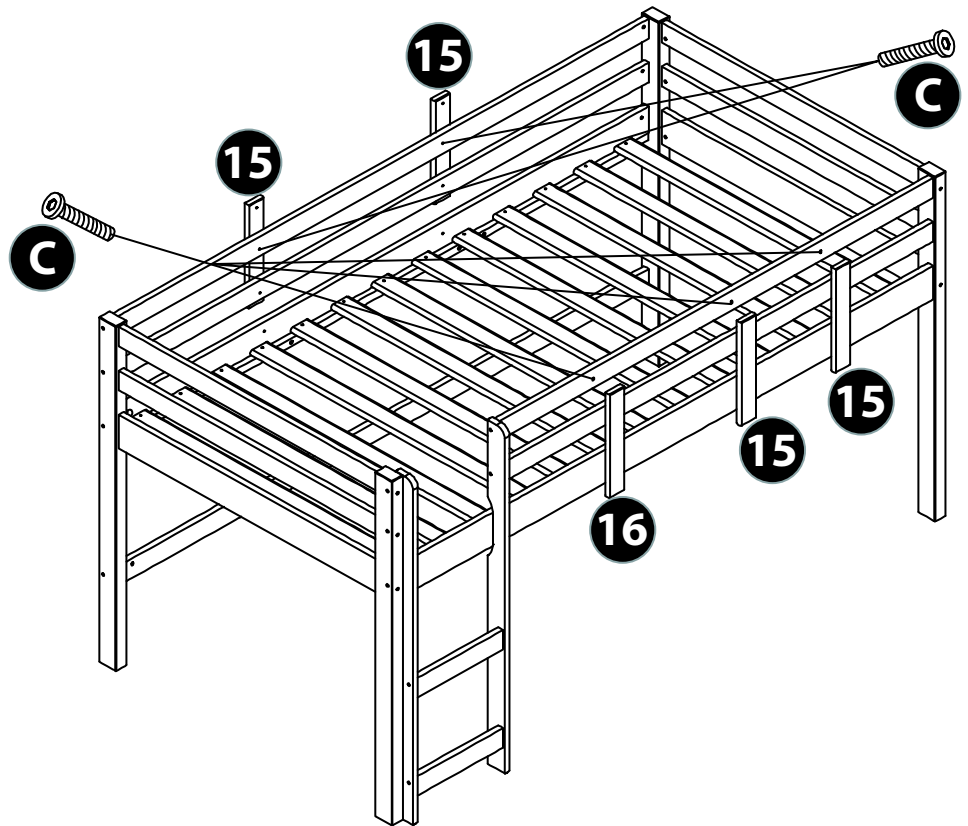

10

Select 17 x13, G x26.
Align 17 and space them evenly over bottom of "L" shape on 7 and 8. Rest 17 ends on 7 and 8. Screw G through end of 17 into 7 and tighten. Repeat for other end of 17 into 8. Repeat for other 12 boards. **Safety check all boards are secure.**

Add your mattress (not included) and follow warning labels for mattress size on part 6.

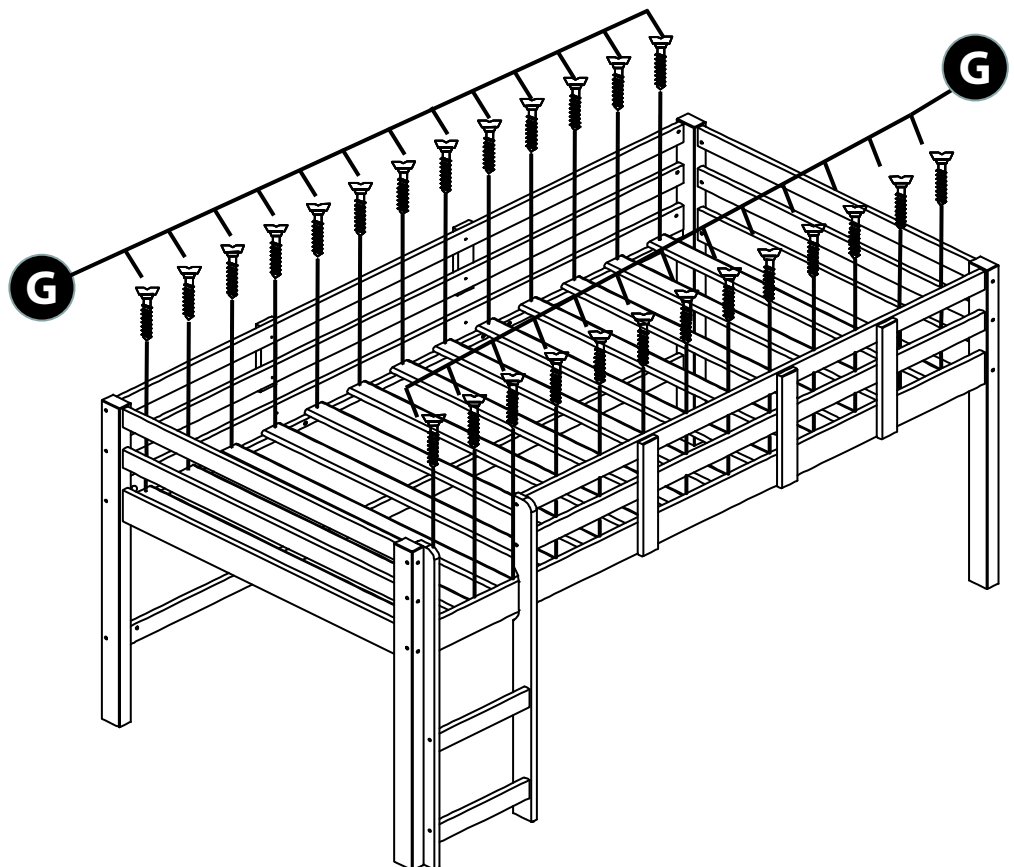

BED FRAME ASSEMBLY COMPLETE

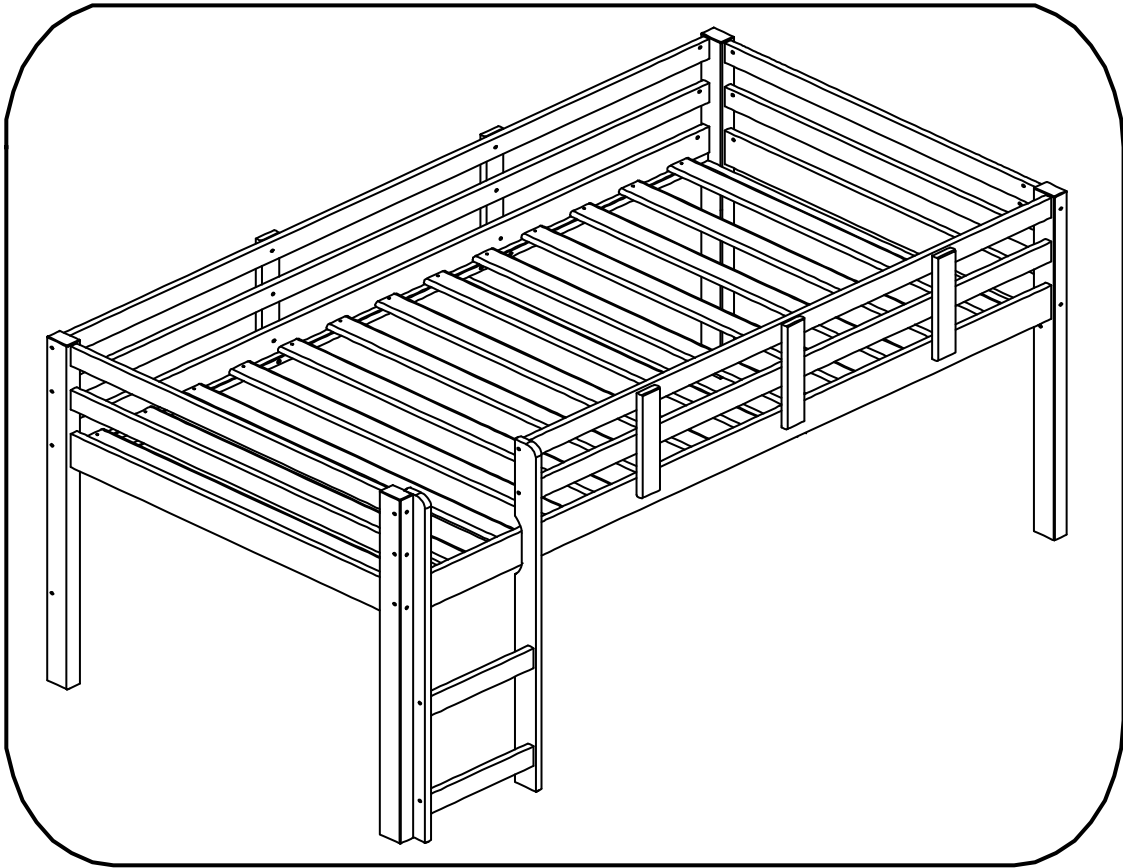

11

Follow steps 11 to 13 to continue assembly of the low loft bed set. Final position bed frame in room. Insert drawer chest under bed frame by ladder on long side. Insert bookcase near ladder on short side.

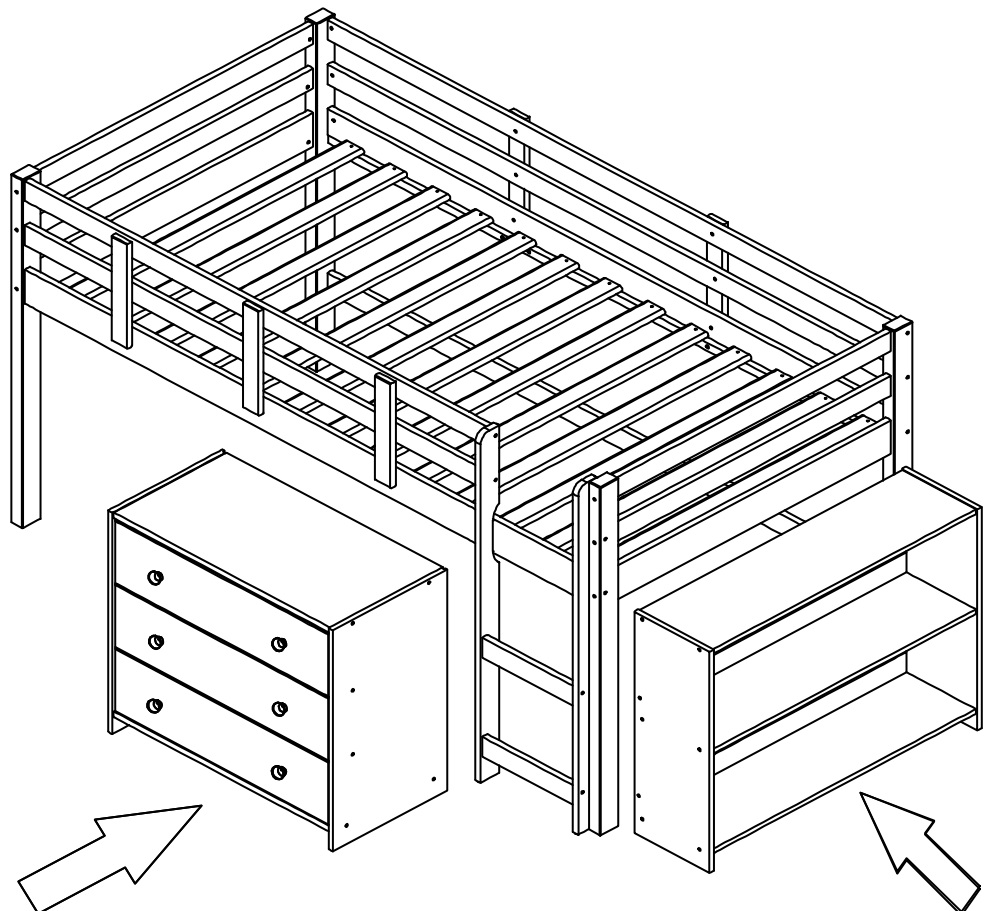

ASSEMBLY INSTRUCTIONS

12

Option 1 - Ladder Right side. Align the desktop to both tracks on the underside of the bed frame. Insert and slide the desktop into the tracks at the same time.

***See Desk Instructions for more details.**

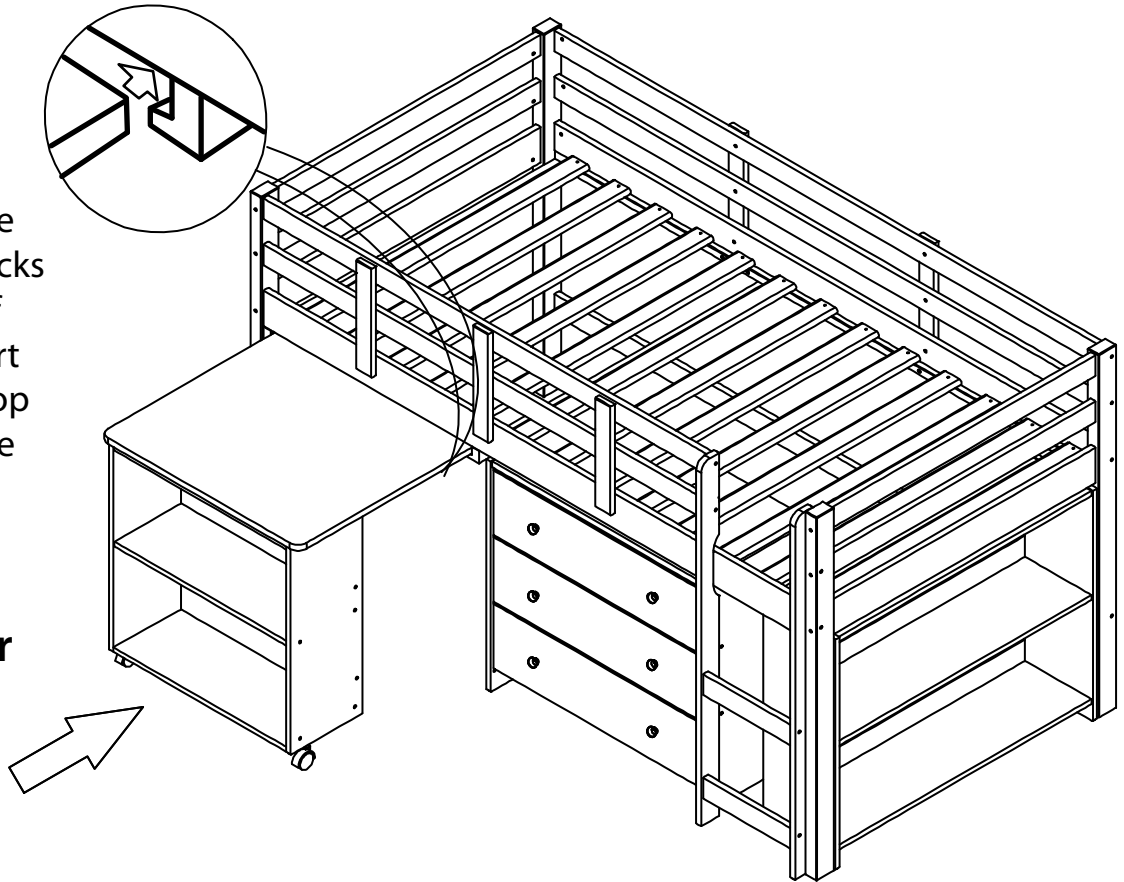

13

Option 2 - Ladder left side. Move the desk tracks to the other bed end. Align the desktop to both tracks on the underside of the bed frame. Insert and slide the desktop into the tracks at the same time.

***See Desk Instructions for more details.**

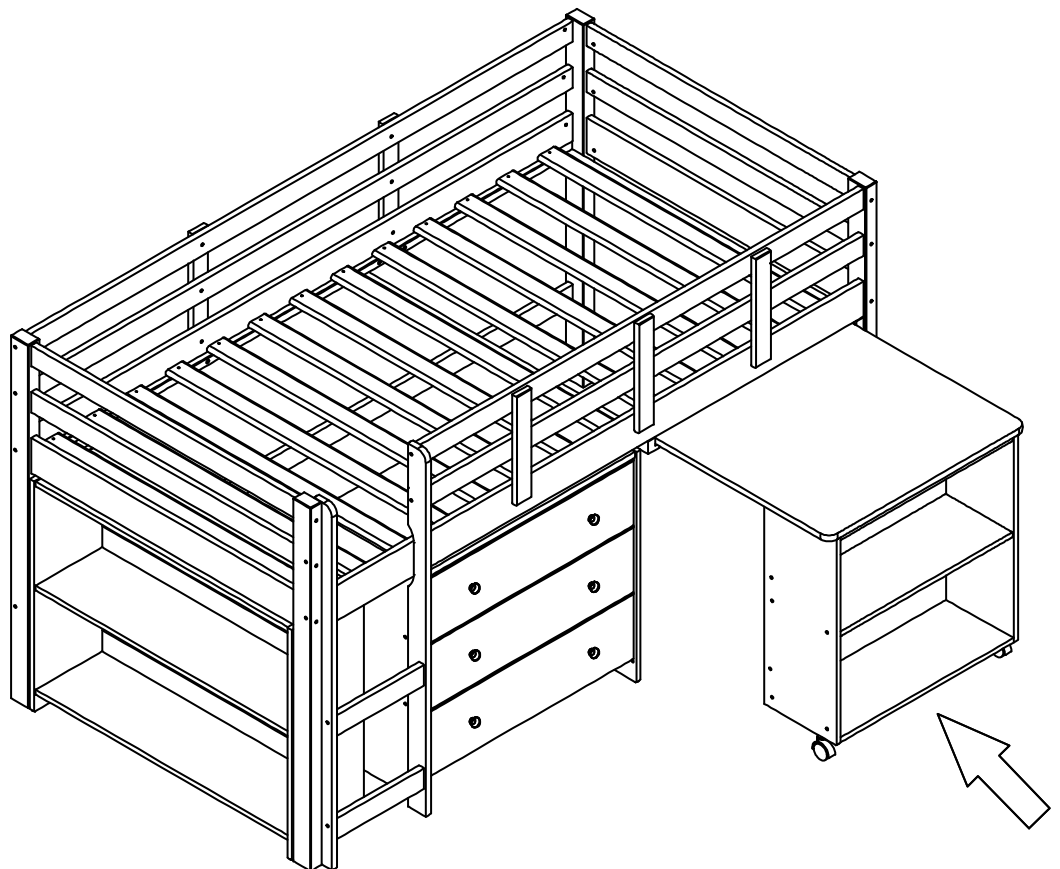

ASSEMBLY COMPLETE

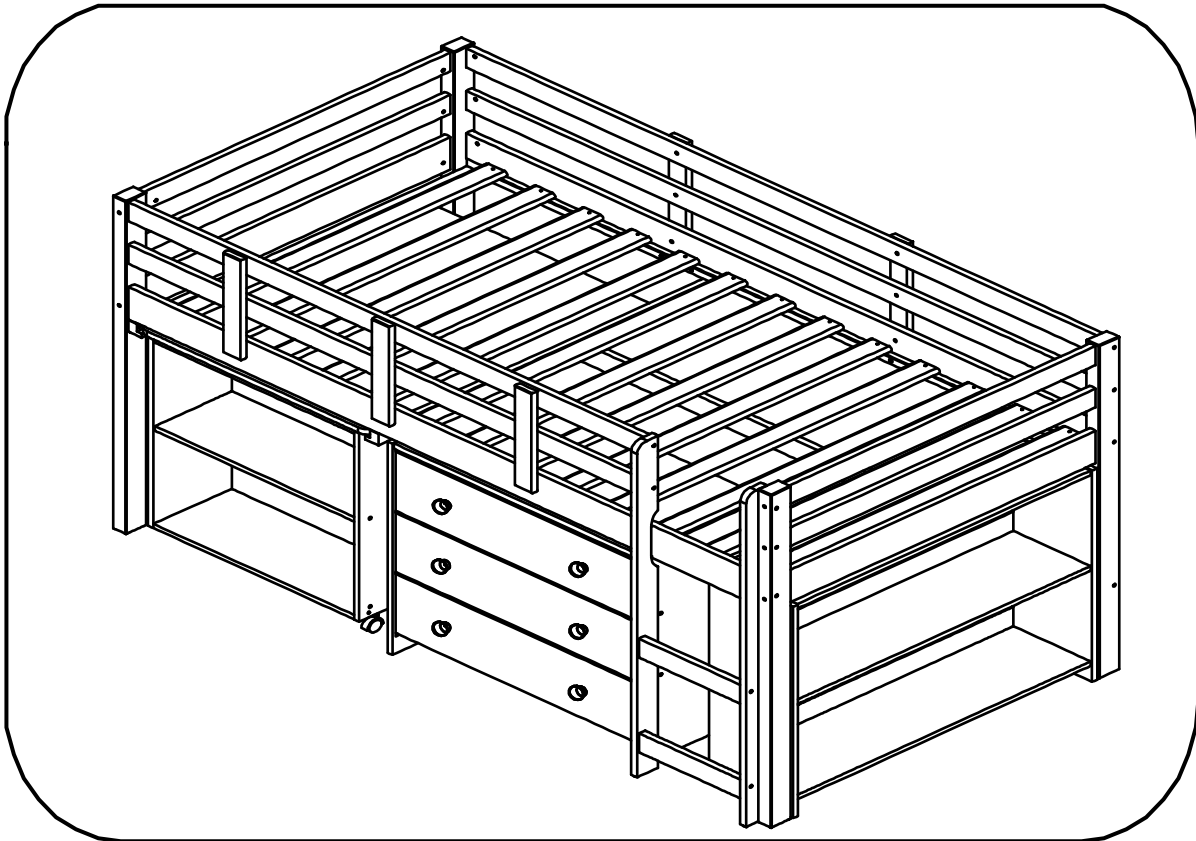

**CONGRATULATIONS, YOUR NAOMI HOME KIDS
LOW LOFT BED WITH LADDER IS COMPLETE!**



www.NaomiHome.com
MADE IN CHINA

Product Packaging Information

Model #: _____

Color: _____

Shipment Ref. #: _____

Date: _____